



TO LET



1 Trinity Gardens, Whittle Way, Brockworth, Gloucester, GL3 4ZF

£1,425 Per Calendar Month



- Available from 07/06/2024
- Unfurnished
- Brockworth
- 3 Bed terraced house
- Motorway access
- EV Charger

Available from - 07/06/2024

THE PROPERTY

Available From - 07/06/2024

Trinity Quarter is situated in a semi urban area of Brockworth just outside of Gloucester. Brockworth is a great area being located close to excellent road links, plentiful retail and leisure services along with being close to employment areas. The area has good schools and is suited for anyone which wants to be located close to services and/or needs to commute the cities Gloucester, Cheltenham or even Bristol. Gloucester and Cheltenham are within a 15- minute drive As a company we always strive to create communities rather than developments and have equipped the development with additional features increasing the desirability of the development.

'The Alveston' is a three bedroom mid terrace property with an open plan kitchen/diner area with, large separate lounge and ground floor WC. The first floor boasts three bedrooms and 1 bathroom. All carpets, light fittings and curtains provided and there is off road parking with Electric Vehicle charging point and landscaped rear garden.

Photos are for marketing purposes only

SITUATION

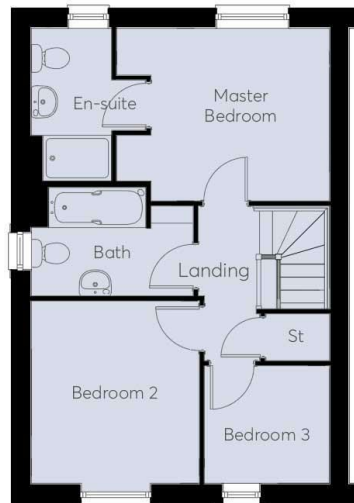

Directions